

10' ALLEY
(ABANDONED)

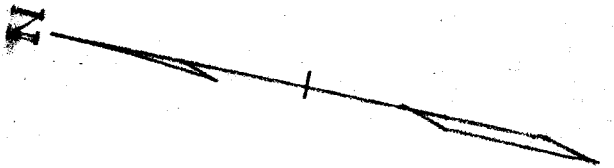
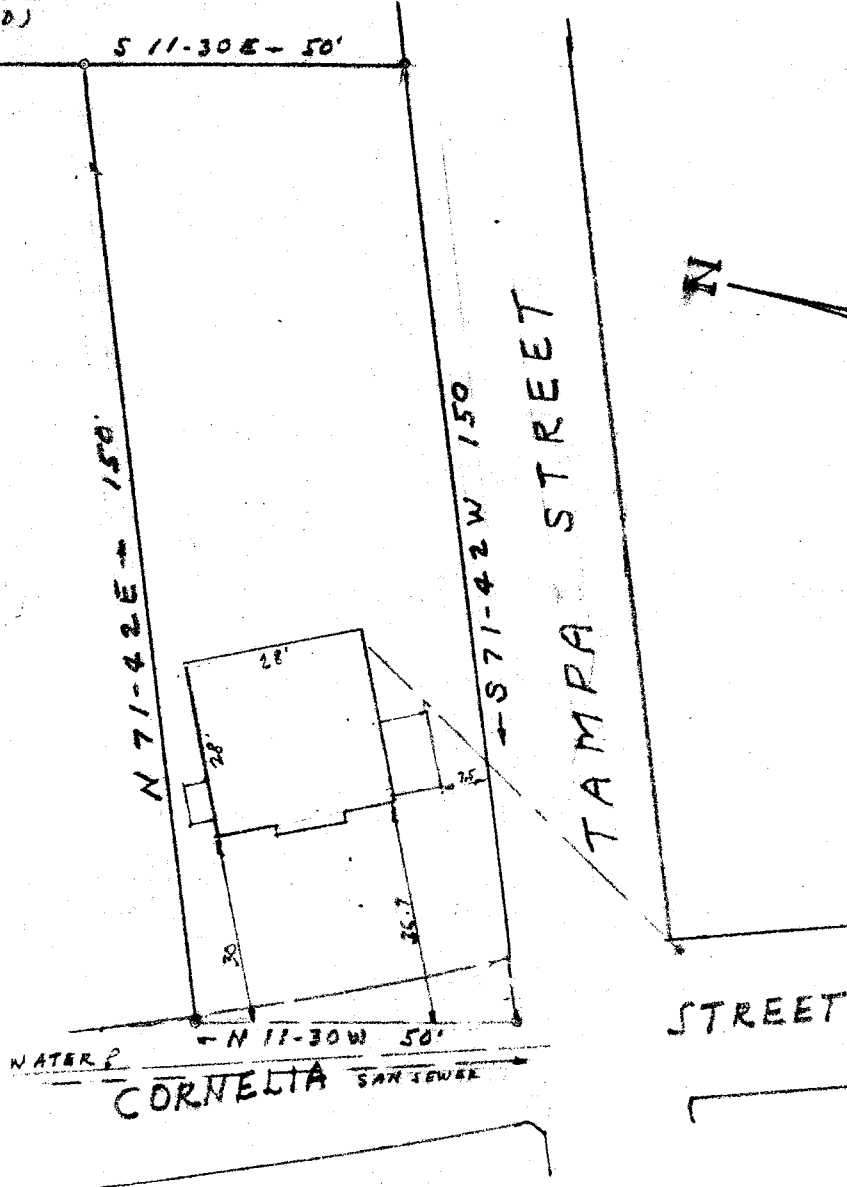

OLLIE JARNSWORTH
R.M.O.

DEC 19 2 49 PM 1966

FILED
GREENVILLE CO. S.C.

This is to certify that on Dec. 9, 1966, I surveyed the property shown on this plat, and that the property lines, walls and building are as shown hereon; that the building located on said lot does not encroach or project on adjacent streets or property, and that no adjacent walls or buildings encroach or project on said premises, and that no utility lines cross this property except as shown hereon.

Surveyed by R.K. Campbell

Campbell & Clarkson, Reg

PROPERTY OF
CHARLES A. COLLINS &
BETTY ANN COLLINS
NEAR GREENVILLE S.C.
SCALE 1" = 30' DEC. 9, 1966

15119

Paste in 506 NNN 135

Filed This 19th day of Dec. 19 66
And Recorded in Vol. NNN Page 135 at 2:49 P.M.
Ollie Jarnsworth
Register Mesne Conveyance Greenville County, S. C.